

**ASME B16.11 (SW)**

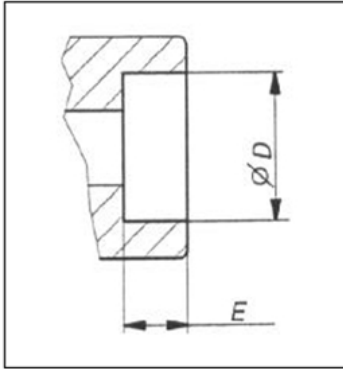

| SIZE   | D min. | D max. | E min. |
|--------|--------|--------|--------|
| 1/4"   | 14.10  | 14.60  | 10     |
| 3/8"   | 17.55  | 18.05  | 10     |
| 1/2"   | 21.70  | 22.20  | 10     |
| 3/4"   | 27.05  | 27.55  | 13     |
| 1"     | 38.80  | 34.30  | 13     |
| 1 1/4" | 42.55  | 43.05  | 13     |
| 1 1/2" | 48.65  | 49.15  | 13     |
| 2"     | 61.10  | 61.10  | 16     |

Dimensions are in (mm)

BSP (BS 21)

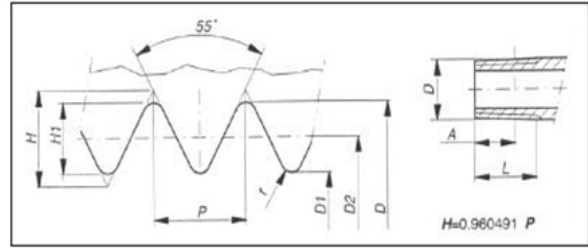

| SIZE   | D      | A    | P     | z  | D2     | D1     | H1    | r     | l    |
|--------|--------|------|-------|----|--------|--------|-------|-------|------|
| 1/4"   | 13.157 | 6.0  | 1.337 | 19 | 12.301 | 11.445 | 0.856 | 0.184 | 9.7  |
| 3/8"   | 16.662 | 6.4  | 1.337 | 19 | 15.806 | 14.950 | 0.856 | 0.184 | 10.1 |
| 1/2"   | 20.955 | 8.2  | 1.814 | 14 | 19.793 | 18.631 | 1.162 | 0.249 | 13.2 |
| 3/4"   | 26.441 | 9.5  | 1.814 | 14 | 25.279 | 24.117 | 1.162 | 0.249 | 14.5 |
| 1"     | 33.249 | 10.4 | 2.309 | 11 | 31.770 | 30.291 | 1.479 | 0.317 | 16.8 |
| 1 1/4" | 41.910 | 12.7 | 2.309 | 11 | 40.431 | 38.952 | 1.479 | 0.317 | 19.1 |
| 1 1/2" | 47.803 | 12.7 | 2.309 | 11 | 46.324 | 44.845 | 1.479 | 0.317 | 19.1 |
| 2"     | 59.614 | 15.9 | 2.309 | 11 | 58.135 | 56.656 | 1.479 | 0.317 | 23.4 |

Dimensions are in (mm)